

From the Management Office

01-1 Exhibition Regulation

01-1-1 Exhibition Outline

01-1-2 Inter BEE 2019 Exhibition Regulations

01-2 Safety Measures

01-2-1 Basic Policy and Organizational Framework concerning Disaster Prevention and Safety Measures **Important**

01-2-2 Requests to Exhibitors Concerning Disaster Prevention and Safety Measures **Important**

01-2-3 Exhibitors' Response to an Emergency **Important**

01-2-4 Disaster Evacuation Route **Important**

01-2-5 Emergency Drill **Important**

01-3 Emergency Conservation Measures

01-3-1 Requests to Help Save Energy **Important**

01-4 Personal Information Protection Law

01-4-1 Personal Information Protection Law **Important**

01-4-2 Use of Personal Information by Exhibitors **Important**

01-5 Inquiries List

01-5-1 Payment of Charges **Important**

01-5-2 Inquiries List **Important**

01

Exhibition Outline

■ Name	International Broadcast Equipment Exhibition 2019 (a.k.a. Inter BEE 2019)
■ Period	November 13th 10:00 a.m. to 5:30 p.m. November 14th 10:00 a.m. to 5:30 p.m. November 15th 10:00 a.m. to 5:00 p.m.
■ Location	Makuhari Messe 2-1, Nakase, Mihama-ku, Chiba City, Chiba Prefecture 261-8550, Japan
■ Admission	Free of charge (registration required)
■ Organizer	JEITA Japan Electronics and Information Technology Industries Association
■ Supported by	Ministry of Internal Affairs and Communications (MIC) Ministry of Economy, Trade and Industry (METI) *listed by date established Japan Broadcasting Corporation (NHK) The Japan Commercial Broadcasters Association (JBA) Association of Radio Industries and Businesses (ARIB) Digital Content Association of Japan (DCAJ) The Association for Promotion of Advanced Broadcasting Services (A-PAB) *no particular order
■ Partners (Planned) *alphabetical order	Advanced Imaging Society Japan Committee Association of Media in Digital Camera & Imaging Products Association Digital Signage Consortium IPDC Forum IPTV FORUM JAPAN JAPAN AD.CONTENTS ASSOCIATION Japan Association of Audiovisual Producers, Inc. Japan Association of Lighting Engineers & Designers Japan Association of Professional Recording Studios Japan Association of Video Communication Japan Audio Society Japan Cable and Telecommunications Association Japan Cable Television Engineering Association JAPAN POST PRODUCTION ASSOCIATION Japan PublicViewing Association Japan Satellite Broadcasting Association JAPAN STAGE SOUND BUSINESS COOPERATIVE Japanese Society of Cinematographers JSL Mobile Broadband Association MOTION PICTURE and TELEVISION ENGINEERING SOCIETY of japan, Inc. MULTISCREEN BROADCASTING STUDY GROUP National Theatrical & Television Lighting Industrial Cooperative Next Generation contents Distributio Forum Projection Mapping Association of Japan Radio Engineering & Electronics Association Specified Radio microphone User's Federation Stage Sound Association of Japan State of the Art Technologies Expression Association The Association of Japanese Animations The Institute of Image Information and Television Engineers Theatre and Entertainment Technology Association, Japan 3D Consortium Ultra-Realistic Communications Forum Visual Industry Promotion Organization
■ Managed by	Japan Electronics Show Association (JESA)

Inter BEE 2019 Exhibition Regulations

1. Booth Standards and Fees

A 1-1. STANDARD BOOTH

1. Booth standards and specifications

- (a). Booth space: 2,970mm(W) x 2,970mm(D)
- (b). Specification:

For exhibitors with 1- to 3-row booths, system panels will be installed as back panels on the sides neighboring booths of other exhibitors. However, system panels will not be placed on the corner-facing sides of corner booths.

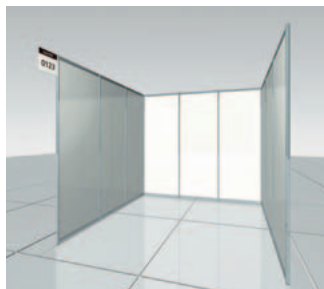

2. Booth fees (Including consumption tax)

The exhibition fee per booth space is as follows:

General exhibitors (standard rate)	¥297,000
Japan Electronics Show Association Members IABM Members (member rate)	¥264,000

For consumption tax, the rate of tax as of November 2019, when this exhibition is held, will be applied.

B 1-2. SMALL PACKAGE BOOTH

1. Booth standards and specifications

- (a). Booth space : 1,980mm(W) x 990mm(D) x 2,700mm(H)
- (b). Specification : The following facilities are included in

- Wall panels
- Display counter (1,000mm high with storage space)
- Fascia (300mm width)
- Company Name Display
- Fluorescent light
- Electrical Outlet (single-phase 100V, up 1 kW output)



* Small package booth exhibitors may apply for up to two booths.

2. Booth fees (Including consumption tax)

The exhibition fee per booth space is as follows:

One booth	¥170,500
Two booths	¥341,000

For consumption tax, the rate of tax as of November 2019, when this exhibition is held, will be applied.

A+ 1-3. PACKAGE DISPLAY KIT

Please select our easy-option "Package Display Kit" when exhibiting at Inter BEE. This will make exhibition preparations much smoother.

Basic Style

One Booth	Booth fee + ¥88,000	
<ul style="list-style-type: none"> · Parapet · Company Name Display · Carpet · Custom Reception Counter 	<ul style="list-style-type: none"> · (1) Folding Chair · (2) Spotlights · (2) Fluorescent Lights · Electrical Outlet (1kW) 	
Two booths	Booth fee + ¥132,000	
<ul style="list-style-type: none"> · Parapet · Company Name Display · Carpet · Custom Reception Counter 	<ul style="list-style-type: none"> · (1) Folding Chair · (4) Spotlights · (4) Fluorescent Lights · Electrical Outlet (2kW) 	

Meeting Style

One Booth	Booth fee + ¥121,000	
<ul style="list-style-type: none"> · Parapet · Company Name Display · Carpet · Custom Reception Counter · Counter Chairs 	<ul style="list-style-type: none"> · Meeting Table · (4) Meeting Chairs · (2) Spotlights · (2) Fluorescent Lights · Electrical Outlet (1kW) 	
Two booths	Booth fee + ¥297,000	
<ul style="list-style-type: none"> · Company Name Display with Logo · Carpet · Custom Reception Counter · Counter Chair · (3) Meeting Table 	<ul style="list-style-type: none"> · (4) Meeting Chairs · (3) Display Counter with Storage · Stock Room · (4) Spotlights · Electrical Outlet (1kW) 	

Premium Style

One Booth	Booth fee + ¥231,000	
<ul style="list-style-type: none"> · Parapet · Company Name Display · Logo Display · Carpet · Custom Reception Counter · (1) Folding Chair 	<ul style="list-style-type: none"> · (3) Display Counter with Storage · Radius Display Counter · (4) Spotlights · (1) Fluorescent Light · Electrical Outlet (1kW) 	
Two booths	Booth fee + ¥462,000	
<ul style="list-style-type: none"> · Parapet · Company Name Display · Logo Display · Carpet · Custom Reception Counter · (1) Folding Chair 	<ul style="list-style-type: none"> · (6) Display Counter with Storage · Radius Display Counter · (8) Spotlights · (3) Fluorescent Lights · Electrical Outlet (2kW) 	

* The price is including consumption tax.

* Power source construction cost and electronics consumption fee for 1kW per a booth are included in package display kit.

* For consumption tax, the rate of tax as of November 2019, when this exhibition is held, will be applied.

Inter BEE 2019 Exhibition Regulations

1-4. Items included in the booth fee

Invitation leaflets cards for visitors	150 per booth	
Badges	For exhibitors	10 per booth
	For constructors	5 per booth
Website listing	1 page per company	

1-5. Other fees

1. The following items are not included in the both fees.

*includes consumption tax

Primary power source construction cost + Electric consumption fee	¥9,900 per kW	
Invitation leaflets and envelops for visitor (in excess of the number of free leaflets and cards indicated above.)	¥44 per set	
Badges	Exhibitors (in excess of 10 badges per booth)	¥1,100 per badge
	Constructors (in excess of 5 badges per booth)	¥550 per badge
Overtime work	¥11,000 per hour	

2. Booth decoration other than basic panels

Booth decorations other than system panels are to be handled by exhibitors.

Rental fixtures, furniture, PC and monitors will be introduced in the Exhibitor Manual.

3. Other

Additional expenses may be charged as required by law and regulations.

Details regarding these charges will be provided in the Exhibitor Manual.



Exhibition Regulations

Inter BEE 2019 Exhibition Regulations

2. Exhibition Categories, Number of Booths and Booth Height Limitations

2-1. Exhibition categories

When an item to be exhibited falls into both categories, two options are possible: the exhibit may either be placed in the category of greatest importance, or the exhibitor may exhibit in both categories. If the Video and Broadcast Equipment Category is selected, the exhibitor may choose to have all overhead lighting on or off.

Exhibition Categories	Overhead lighting
Professional Audio Equipment	●●●● Full overhead lighting (approx. 500 lux)
Video Expression / Professional Lighting Equipment	●●●● All overhead lighting off (approx. 50 lux)
Video Production / Broadcast Equipment	●●●● Full overhead lighting (approx. 500 lux) or ●●●● All overhead lighting off (approx. 50 lux)
ICT / Cross-media	●●●● Full overhead lighting (approx. 500 lux)

■ Exhibitors in the Video Expression / Professional Lighting category may illuminate towards the ceiling; however, considering the influence on surrounding exhibitors, please note that this kind of exhibitors' booth will be located at the far end of the show space.

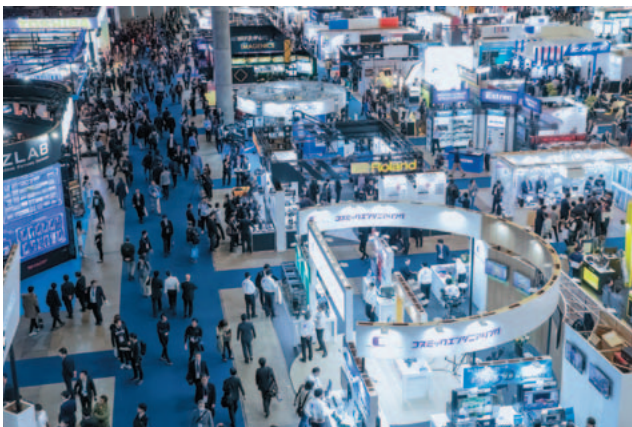

2-2. Number of booths and booth type

1. Exhibitors in rows (less than 18 booths) may have booths of other exhibitors on one or three sides.
2. Industry organizations and joint exhibitors may apply for more than 100 booths.
3. After the deadline for applications, the Organizing Committee will determine the layout of the show site. If the total space applied for exceeds the capacity of the site, the Organizing Committee reserves the right to determine an impartial method to reduce the number of booths applied for by exhibitors.

	Booth Type	Number applied for
Standard booth	■ 1 row	1, 2, 3, 4, 5, 6
	■ 2 rows	4, 6, 8, 10
	■ 3 rows	9, 12, 15, 18
	■ 4 rows	16
	■ Block format	20, 25, 30, 35, 40, 45, 50, 55, 60, 65, 70, 75, 80, 85, 90, 95, 100
Small package booth		1, 2

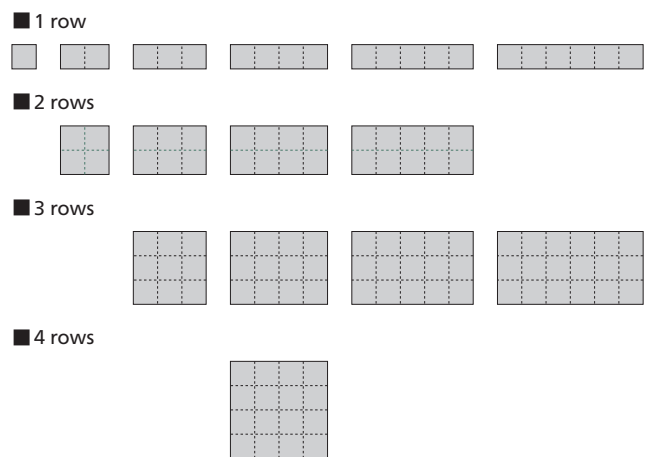

The standard for block booths is: 1 booth space = 9 m². The floor will be marked in an area equal to (W:D) 2:1 or 1:1 based on the total floor space reserved (9 m² x no. of booth spaces). The actual dimensions will be provided to exhibitors at the lot drawing for booth space allocation.

[Sample booth dimensions]
Example of an application for 25 booth spaces: Dimensions are marked out for an area of 225 m² (9 m² x 25 booth spaces), ranging from a rectangular shape with a wider entry dimensions than a square.

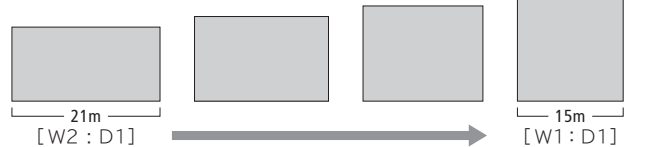

Inter BEE 2019 Exhibition Regulations



2-3. Booth height limitations

The standard height is 2.7m. Details of booth wall heights are shown below.

1. 1 to 10 booths

The allowable height of booth walls set back 1.0m from the corridors and / or foundation panels will be 3.6m.

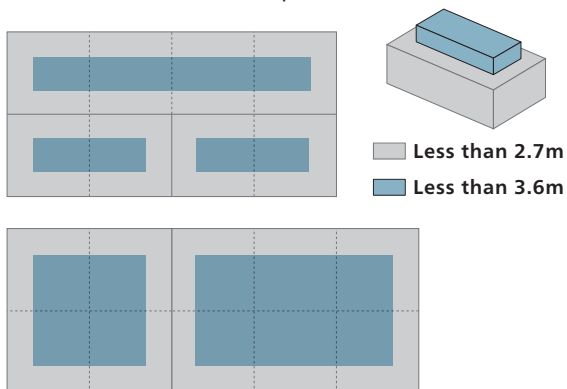

2. 12 to 18 booths

The allowable height of booth walls set back 1.0m from the corridors and / or foundation panels will be 4.5m.

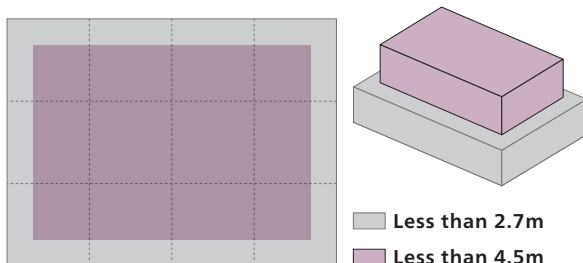

3. More than 20 booth spaces (block booths)

The height limit is 6m.

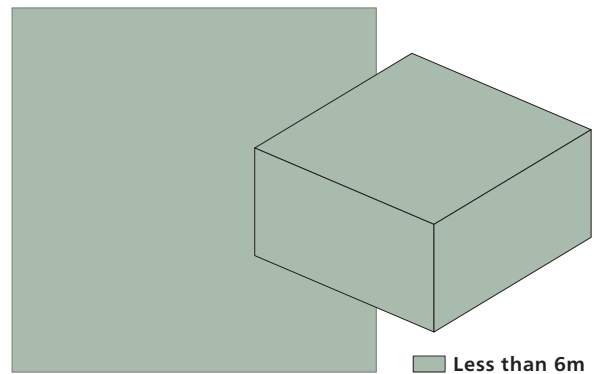

4. If product sizes exceed height limitations

The height limitation on product exhibits and decorations is stipulated above. If exhibited products exceed these height limitations, the exhibitor should submit Application for Over-Regulated Heights and booth plan drawing to the Show Management Secretariat and the exhibitor must receive prior permission from the Inter BEE Organizing Committee.

In this case, product exhibits are to be displayed within the specified area of the exhibition booth (the setback should be 1.0m from the corridors and / or foundation panels) and in no way must any display encroach upon corridor space. Exhibited products that have received prior permission to exceed height limitations must be exhibited in their original state. No additional decorations are permitted.

Inter BEE 2019 Exhibition Regulations

3. Exhibition Application, Payment of Booth Fees and Allocation of Booths

3-1. Exhibitor eligibility

Corporations and organizations involved with products included in the following list or related businesses are eligible to participate in Inter BEE:

- Equipment manufactures
- Electronic components, devices, and materials manufacturers
- Broadcasting and communications companies
- Software and content production companies
- Trading and distribution companies
- Service companies
- Newspapers, magazines and other publishing companies
- Educational and research institutes
- Government organization, administrative corporations, public-interest corporations, nonprofit public and industry organizations

1. Advertising companies and other related agencies are not allowed to represent any company that exhibits products even if said products are included in the aforementioned list of eligible businesses or products.
2. Applications from any persons involved in bankruptcy, composition, receivership, civil rehabilitation, or corporate reorganization proceedings, or persons who are suspended from current account transactions from financial institutions will not be accepted.
Similarly, applications from any persons deemed by the Association to be involved in similar circumstances will not be accepted. If an exhibitor company is found to fall into one of the categories described above after the contract has been concluded, the contract will be voided and that company will not be permitted to exhibit. In such a case, participation fees paid by exhibitors will be refunded.
3. The Organizing Committee reserves the right to refuse applications from companies that have violated regulations at a previous show or whose activities may be considered detrimental to visitors and/or other exhibitors regardless of in prior to or after holding an exhibitor contract. In such case, paid booth fees will be refunded. (see section 2-4: Exhibit application and contract agreement)
4. Regarding to the above, if deemed necessary by the Association, an investigation or inquiry into the surrounding circumstances will be conducted.



3-2. Exhibition application and contract agreement

To apply for and contract exhibition space, fill in the information required on the exhibition contract application form, and submit the form to the Show Management Secretariat of the Japan Electronics Show Association (JESA), which will confirm your full understanding of the exhibition regulations. Upon receiving the application form, the Show Management Secretariat will send a receipt confirmation notice via e-mail. The receipt date stated in this confirmation e-mail is regarded as the contract date, whereupon exhibitors are liable for participation fees. If applying in multiple categories, a separate application is required for each category. However, the Organizing Committee reserves the right to advise exhibitors on the most appropriate location for their booths. In addition, exhibitors are required to submit one application per Category if applying for booth spaces in multiple Categories.

1. Application deadlines

First application deadline	Thursday, May 31 st	Applicants may participate in the primary booth allocation drawing.
Second application deadline	Friday, June 28 th	Applicants may participate in the secondary selection.

*Even prior to these deadlines, no more applications will be accepted if all booth spaces have been filled.

After the second deadline

Applications will be accepted after June 29th, 2019 or until all available booth spaces are taken.

2. Applications should be sent to:

Japan Electronics Show Association (JESA)

5F Ote Center Bldg., 1-1-3 Otemachi, Chiyoda-ku, Tokyo 100-0004
TEL: +81-3-6212-5231 FAX: +81-3-6212-5225
E-mail: contact2019@inter-bee.com

3. Submitting a company profile

First-time exhibitors to the show are required to provide a company profile and catalog(s) of product(s) planned to be exhibited upon submission of the exhibit application / contract. And, if there are major changes made to the corporate profile or catalog(s) of product(s) planned to be exhibited after the company has submitted these documents, an updated profile and / or catalog(s) must again be submitted. Applications without these documents will be put on hold until the Show Management Secretariat confirms the receipt of these items.

3-3. Cooperative exhibitions or neighboring exhibitions which involve more than two companies

Exhibitors who wish to maximize the effects of exhibitions by holding cooperative exhibitions with group / affiliated companies in one booth or neighboring exhibitions with other companies, must submit applications according to the following criteria.

1. Collaboration exhibitions (If an application is made by one firm, but wishes to exhibit under the names of multiple companies)

- (a) One of the exhibiting companies should submit an application and pay booth fees.
- (b) Please fill in and submit "Collaboration exhibitor registration form" which is sent to you by the Show Management Secretariat upon completion of application of cooperative exhibitions. By submitting this form, you can print the names of affiliated companies on the lists and the layout.

Inter BEE 2019 Exhibition Regulations

2. Neighboring exhibitions (If multiple firms join together booths and use them as a one space)

- (a) Each company should apply and pay its booth fees separately.
- (b) The total number of booths requested by each company conforms to the standard booth specification and configuration.
- (c) The position of booths will be decided by the lot drawing among the total number of booths applied for.
- (d) We will confirm if the panels on the sides neighboring booths of other exhibitors and booth numbers are available on the questionnaire.

3. Cooperative exhibitions (When multiple companies wish to exhibit in close proximity across a passageway)

- (a) We will accept applications for partner exhibits only in the following cases:
 - Applications by group companies with capital ties
 - Applications by companies with a formal reseller contractual relationship (must have been made public)
 - Applications by one dealer exhibiting with different brand names
 - Applications by companies exhibiting products and services that have been jointly developed in the booths of both parties. (must have been made public)
- (b) Each of the companies applicable to one of the above must make an exhibit application and pay the booth fee.
- (c) The position of the booths shall be limited to locations other than Exhibit Halls 4, 5 and 6. The Management Office will determine the position of the booths in advance. It is not possible to select the position of the booths. Please also understand in advance that it may not be possible to meet your requirements depending on the shape of your booths.
- (d) We cannot accept applications for partner exhibits for the purpose of fixing the position of your booths outside the lottery.
- (e) We do not allow linking of standard booths and small package booths.
- (f) Please be aware we reserve the right to refuse applications if we cannot verify validity of the cooperative exhibitions. Also, please be aware that we cannot accommodate your requests concerning the configuration of booths.

3-4. Payment of booth fees

Booth space payments are to be paid via electronic bank transfer according to the schedule below. JESA will issue an invoice and designate the bank account for remittance at this time. Checks and promissory notes are not acceptable as payment. Transfer fees are to be borne by the exhibitor.

Primary applicant	Tuesday, July 31 st , 2019
Secondary applicant	Friday, August 30 th , 2019

3-5. Cancellation or reducing the number of booths

If an exhibitor cancels or reduces the number of booth spaces applied or, regardless of the reason, some or all of the following cancellation fees will apply. Consumption tax will be added to all fees.

July 1st to July 31 st , 2019	60% of exhibition booth fee
August 1st to August 31 st , 2019	80% of exhibition booth fee
On or after September 1 st , 2019	100% of exhibition booth fee

Please notify us promptly of cancellations of exhibitions, and additions / reductions of booth spaces. Please fill in and submit "Application for booth cancellation or changes for number of booth(s)" that is sent to you by the Show Management Secretariat. The Show Management Secretariat will inform you that it has received the application as a confirmation.

3-6. Allocation of booths

Booth locations will be determined by lot drawing. Lots will be drawn among exhibitors who have the same number of booths or share the same configuration in the same categories. However, depending on actual conditions at the booth allocation, lots may be drawn among exhibitors who have approximately the same number of booth spaces (±10 spaces) in the same stage (i.e. exhibitors with 25 to 35 booth spaces). In addition, exhibitors in the Professional Lighting category may illuminate towards the ceiling; however, considering the influence on surrounding exhibitors, please note that such exhibitors' booth will be located at the far end of show space.

► The drawing of lots is scheduled for July 18th.

Primary lot drawing

Exhibitors who have submitted applications by Friday, May 31st, may participate in the primary lot drawing. Please be aware that the number of booths can be changed until the end of June and that the Organizing Committee may adjust the order of the drawing in the event that exhibitors change the number of booths for which they applied to fit their needs after the end of June.

Secondary selection

Exhibitors applying from Thursday, June 1st, through Friday, June 28th, may select their booth locations from the locations that remain vacant, in the order of which applications are received.

1. Spare booth spaces

If booth spaces remain available at the end of the lot drawing dates, the remaining spaces will be placed on the floor as spare booths. Exhibitors submitting applications after Saturday, June 29th can select their booth locations from the available spare booths on a first-come, first-served basis.

2. Fixed booth spaces

The Organizing Committee has determined the following booth spaces to be fixed:

- (a) Because lots are drawn among exhibitors with the same number and type of booths in the same exhibit zones, an exhibitor not meeting this criterion will be afforded a fixed booth space(s).
- (b) Cooperative exhibitors
- (c) Overseas cooperative exhibitors and related domestic exhibitors.

3. Spare spaces

Utility booths will be setup in spare open spaces after the booth lot drawing is completed. However, exhibitors should be aware that further changes in booth allocation may occur due to exhibitor cancellations, reduction in booth spaces, etc.

4. Entry ways of booths

The position of entry ways and the use of block booths by exhibitors may be adjusted by the Organizing Committee in consideration of overall visitor flow.

5. Overhead lighting

Full overhead lighting delivers approximately 500 lux, but exhibitors in the Video Production and Broadcast Equipment category may choose to locate their booths in areas where all overhead lighting is decreased (approximately 50 lux). Please note that this option may not be available, depending on the ratio of visitors requesting overhead lighting.

Inter BEE 2019 Exhibition Regulations

4. Important Exhibit Details and Prohibitions

4-1. Exhibiting of products from outside of Japan (including fixtures)

Inter BEE plans to make all exhibition halls open to the display of bonded goods. Therefore, it will be possible for exhibitors to display overseas products (those manufactured outside Japan or items that have not yet cleared Customs proceedings) even if they have not cleared Customs by the time the exhibition begins.

4-2. Applications regarding industrial property rights

Part of the Patent Law has been revised and the application items of regulation concerning exception to lack of novelty of invention have been reviewed.

Due to this revised law, the designated system of exhibitions was abolished from 1st April, 2012, and disclosure type restrictions were removed from the old system where application items were restricted except for certain exhibitions. Exhibitors who plan to file an application for patent, utility model or trademark, should directly contact the General Affairs Division of the Patent Office.

4-3. Prohibited activities

The following activities are considered as prohibited:

1. Exhibit space transfer

Subletting, selling, transferring, or exchanging exhibition space, either in whole or in part, to any third party, including other exhibitors.

2. Directing visitors to other venues

Directing Inter BEE visitors to simultaneous product or technology exhibits off-site is prohibited.

3. Engaging in sales activities

Selling products other than publications and software on-site except in designated area during the show is prohibited. Exhibitors who wish to sell publications and software are required to submit details and seek approval in advance.

4. Inappropriate behavior

Aggressively attempting to attract visitors to view demonstrations while standing outside of booths or in aisles is prohibited. Persistent sales approaches and/or techniques considered to be excessive are also prohibited.

5. Exhibiting for the purpose of obtaining personal information

It is prohibited to use booths for the primary purpose of collecting personal information on visitors, rather than to display products and services. Furthermore, all exhibitors are requested to abide by the stipulations in Japan's personal information protection legislation. Details on the collection and handling of personal information will be available in the Exhibition Manual.

4-4. Responsibilities of exhibitors

1. Prompt fee payment

Exhibitors will pay all exhibitor fees and expenses invoiced by Show Management Secretariat and bear responsibility until all payments are complete.

2. Obeying the law

The laws and regulations of Japan shall be followed in all cases related to the transfer and management of display and related items, and in management and other matters related to constructs and structures for use in exhibits.

3. Liability for damage, management of exhibited items, and insurance.

(a) The sponsors, organizing committee and Show Management Secretariat will make every effort to ensure the security of exhibits during the show period by, for example, implementing security guard patrols. However, the management cannot assume responsibility for damages arising from natural disaster, fire, theft, loss of property or other occurrences beyond its control and recommends that exhibitors take steps of their own.

(b) Exhibitors shall be liable for any fatalities or injuries occurring to visitors, other exhibitors or third persons as well as damage to items at the exhibition site. Inter BEE sponsors and / or the organizing committee shall bear no responsibility whatsoever in such circumstances.

(c) A booth manager, whose responsibility is to supervise all activities that take place in the exhibitor's booth, must be confirmed with the organizer prior to the start of the exhibition.

(d) Exhibitors are recommended to provide for adequate insurance coverage during the exhibition.

(e) The organizer will make every effort to provide effective management, enhanced safety, and maintenance of order at the venue as well as ensure the safety of exhibition visitors. Any act by an exhibitor(s) that is considered detrimental to the aforementioned may lead to the termination of that exhibitor's demonstration. Exhibitors shall be liable for any accidents that may occur during exhibitor demonstrations, and Inter BEE sponsors and / or the organizing committee shall bear no responsibility whatsoever in such circumstances. In the event of an accident, the exhibitor is required to take appropriate action and report it immediately to the organizer.

4. Complying with the exhibition schedule

Prior, during and after the show, all exhibitors are requested to comply with the exhibition schedule specified by the organizer. Construction activities to the booth, delivery and/or wrap-up activities during the exhibition are prohibited.

4-5. Termination or shortening of exhibition duration due to unavoidable or potential calamity

1. If the exhibition is canceled because of an event of force majeure, such as an earthquake, typhoon, fire, disease, terrorist act or order from the public authorities, the organizers reserve the right to shorten the duration of the exhibition or the hours that the exhibition is open to the public, either before or during the exhibition. If the exhibition sponsors deem such action necessary, this information will be promptly published on the official Website and exhibitors will be notified. Neither the exhibition organizers nor the Association shall assume any liability for losses incurred by exhibitors in such a case.

2. If an unavoidable calamity that occurs prior to the opening of Inter BEE forces cancellation of the exhibition, participation fees paid by exhibitors will be refunded in full, minus charges for expenses already incurred.

3. Neither the exhibition organizers nor the sponsors shall be held liable to refund exhibition expenses, either in full or in part, if the exhibition duration is unavoidably shortened because of a calamity or potential calamity.

4. The exhibition sponsors and the Show Management Secretariat assume no responsibility for expenses incurred by exhibitors if the exhibition is canceled or shortened because of a calamity.

4-6. News gathering and filming

Staff members appointed by the sponsors and / or the organizer will be authorized to gather news and / or conduct interviews as well engage in filming and / or photography. Exhibitors are requested to cooperate with such news gathering and filming activities and also agree that any image, photograph, information, etc. obtained during the exhibition can be used solely for the purpose of promoting Inter BEE.

4-7. Dealing with disputes between exhibitors

Any disputes between exhibitors concerning exhibits, publicity materials related to exhibits, intellectual property or the use of booths shall be resolved between the parties concerned. The exhibition sponsors shall bear no responsibility whatsoever in such instances.



Inter BEE 2019 Exhibition Regulations

4-8. Booth design

Product exhibits, demonstrations, etc., must be conducted within the exhibitor's booth. If for some reason this rule is not followed properly, the organizing committee and / or the Show Management Secretariat will request that the exhibitor comply with the rule; any further noncompliance may result in termination of the exhibitor's booth.

1. Prohibition of usage of space beyond booth boundaries

- (a) Exhibitors are responsible for controlling crowds around their booths, which might block walkways in public spaces. If a stage is set up in a booth, the Exhibitor must ensure that the booth layout makes it possible to bring all visitors inside the boundaries of the booth.
- (b) Inviting visitors into booths and/or conducting surveys in walkways in public spaces is strictly prohibited.
- (c) Exhibits, decorations, fixtures, plants and packaging materials should not be left outside of booths, but must be stored within booths.
- (d) Product exhibitions and presentation acts using the space outside the booth such as the aisle is prohibited.
- (e) Projecting rays and lights on aisles and venue walls or ceilings is forbidden except for exhibitors in the "Video Expression/Professional Lighting Category". However, an exception approval will be required in advance to exhibit lighting products in categories other than "Video Expression/Professional Lighting".

2. In-booth stages

Exhibitors planning to set up a stage in their booths must ensure that the booth layout makes it possible to bring all visitors inside the boundaries of the booth. Further more, depending on the height of the stage and the video equipment installing, take sufficient care of the visitors viewing angle and of an appropriate distance. If any problems occur in line with in-booth stages, the Show Management Secretariat will request immediate countermeasures.

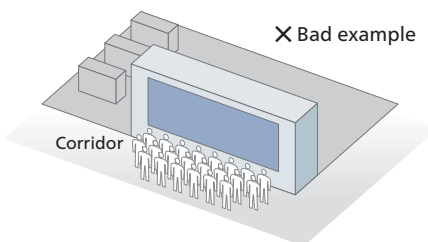
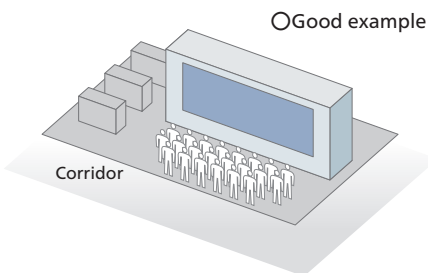

3. Thoughtful independent booth design that allows for an evacuation route

When designing an independent booth, be sure to fully consider the location of adjacent companies' booths, and carry out thoughtful design that allows for an evacuation route and does not obstruct the view of adjacent companies' booths.

4. Speakers

Exhibitors are prohibited from setting up public address systems, such as loudspeakers or mixers, directly facing neighboring booths.

So as not to inconvenience visitors or neighboring booths, these systems must be positioned facing the stage. If installing loudspeakers on booth walls or displays fixture pillars, the central axis of each speaker must be 45 degrees or less.

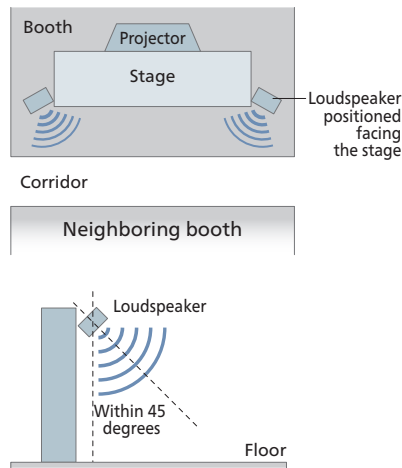

5. Safety Measures

- (a) To prevent truss beams falling, strike four or more anchor bolts in one place when securing them to the floor.
- (b) When installing exhibition panels (OCTANORM), take measures to prevent them falling by reinforcing the panels, reinforcing the beams in the corner sections, and installing weights.
- (c) Take measures to prevent independent fixtures falling by securing them to the wall or floor surface.
- (d) When installing video monitors, speakers, channel characters, lighting fixtures, and other fixtures.



4-9. Ceiling structure and two-floor construction

Installing a ceiling on the booth is only permitted when products and/or demonstrations need to be shielded from light or insulated from sound. The ceiling must be made of a fireproof blacked-out curtain, which is the only material permitted under local fire department restrictions. Direct sunshine will be blocked out within the exhibit halls but there still may be some reflections cast from the indirect and ceiling lighting. Exhibitors who wish to set up ceiling structures, without regard to the size or area, are required to submit an application form sent with the Exhibition Manual together with top and elevated view booth drawings. Observe the following guidelines for the design and construction of a ceiling structure.

1. Ceiling structure

- (a) Any double layer structure is prohibited.
- (b) All the decorating materials must be fire-resistant processed and attached the fire-resistant indications.
- (c) Exhibitors are required to submit both top (designated ceiling area and its size) and elevated view (designated ceiling area and surrounding wall, etc.) booth drawings. They must show that the ceiling are fire-resistant processed.

2. Fire Safety Equipment

- (a) Fire extinguishes must be size 10 or larger.
- (b) Fire alarms (smoke alarms) may be required. In such case, exhibitors must submit the placement notice and its operation experiment result to the Management Office. Domestic fire alarms are not be accepted.
- (c) Depending on the structure or size, evacuation exits and leading light for emergency may be necessary.

3. Two-floor construction / Suspended Structure

Two-story structures and suspending decorations from the ceiling are not allowed.

Inter BEE 2019 Exhibition Regulations

4-10. Floor work

Exhibitors who require floor construction work are required to submit an application form sent with the Exhibit Manual together with a floor plan. Observe the following guidelines for the Floor Construction Work.

- Exhibitors are required to contact the Management Office in each hall before commencing the work and inform the number of anchor bolts to be affixed.
*In case there is no need of anchor bolts, exhibitors are required to submit the cancellation
- Concrete nails and jackhammering are prohibited. No construction may be carried out on pit covers or pit interiors on the floors.
- To prevent truss beams falling, strike four or more anchor bolts in one place when securing them to the floor.
- Floor construction work is permitted on the condition that all flooring will be restored to its original state after the show. After usage, if the bolt heads project above the surface, they must be sawn off, not hammered in or cut with acetylene torches. All expenses for restoration shall be borne by the exhibitor. In the event that the floor is not restored to its original condition after the final floor inspection, or the restoration is incomplete, the Management Office will complete the restoration work and charge the total amount of expenses to the exhibitor after the show.
- When bolting down an anchor bolt, a cooperative fee for the restoration of floor surfaces of ¥1,100 per bolt will be charged to the exhibitor regardless of the size of the bolt.
- Carpeting a booth, exhibitors are required to use double-faced tape. Use of glue is prohibited.

4-11. Fire prevention regulations

Inspections by the local fire department will be carried out during the display construction work of after its completion. Any work not in accordance with the below regulations may be suspended, or the structure(s) in question removed. Exhibitors are required to follow the instructions below.

- Any type of material, whether cloth or paper, affixed to plywood for display purposes should be fireproof.
- Materials such as display mountings, artificial flowers, draperies, drop curtains, display plywood, fiber blinds, blackout curtains, carpeting or other flammable materials must be fireproof. Please attach a Fireproof tag to each of these materials in an easily visible location.
- Avoid using paper flowers, urethane, acetate, polyester, nylon or other materials that are difficult to fireproof.
- The use of plastic foam is prohibited. Please substitute Styrofoam or similar materials.

4-12. Counterfeit or imitation products are strictly prohibited

- The display, distribution, or demonstration of counterfeit or imitation products that infringe on a third party's intellectual property rights (e.g. patents, trademarks, design rights, copyrights, overseas rights, etc.) or any other related activity is strictly prohibited.
- If the Organizing Committee discovers counterfeit or imitation products being displayed, distributed, or demonstrated, it reserves the right to remove these products from the exhibition venue immediately with all costs incurred becoming the responsibility of the offending exhibitor.
- In addition to inspections for counterfeit or imitation products, all exhibitors shall cooperate with the Organizing Committee whenever any type of inspection is conducted.
- Any disputes concerning the intellectual property rights of exhibited products shall be resolved between the parties concerned.

4-13. Comparison displays

As a general rule, exhibitors are requested to limit product comparisons (see guidelines below) to demonstrations between products and / or technologies of their own company or group companies. Exhibitors who plan to compare their products or technologies with those of other companies should first obtain advance permission from the other company and such comparisons must not infringe upon the property rights of that company.

- Comparisons using exhibits and demonstrations.
- Comparisons using information panels and pamphlets.
- Verbal comparisons in audio announcements.
- Other comparisons related to products and technologies.

When the organizers and / or Organizing Committee determine that the aforementioned guidelines on comparison displays have not been observed, they reserve the right to terminate the display or order that corrective measures be taken with all costs incurred by the exhibitor. If said corrective measures are determined to be insufficient, the exhibitor may be barred from future participation in Inter BEE.

4-14. Suitable displays

The following regulations must be strictly observed for all displays in the exhibition booths.

- Safety and precaution signage**
All booths must have adequate safety and precaution signage positioned in clearly visible locations around the displays.
- Displays should reflect real-life situations**
Product presentations and / or displays should be demonstrated in real-life situations as much as possible and not in an exaggerated or unrealistic manner. If this is not practical, the product(s) must have accompanying captions stating how they are used in actual applications.

4-15. Vehicle display

When displaying broadcast relay vans or other vehicles, please be certain that the vehicle can be stored within the space stipulated by the booth specifications. If this height is exceeded, submit "application for Over-Regulation Heights" in the Exhibition Manual.

4-16. Restrictions on Audio Volume

When explaining products or making demonstrations, audio volume in the booth must be maintained at the levels less than 75dB. Please remember that it is important to maintain audio volume at reasonable levels to ensure that visitors can hear the presentations of other exhibitors.

- The value is the standard, when measured from 2 m away from the border line of booth. These levels must be observed throughout every booth.
- During the exhibition period, the Show Management Secretariat will regularly measure sound levels. Exhibitors are also asked to voluntarily measure sound levels within their booths before and during the exhibition. Contact the on-site Management Office to borrow measuring equipment.
- Breach of noise-level restrictions: Any exhibit exceeding the specified noise levels must be modified to conform to regulations. Failure to conform may result in the loss of exhibiting privileges.
- Regardless of these regulations, if complaints are received from neighboring exhibitors or noise is noticeable in other areas of the site, the Show Management Secretariat will require the exhibitor in question.
- Please make sure that a person responsible for audio equipment is stationed in your booth at all times, and that the audio equipment is operated in accordance with the regulations.

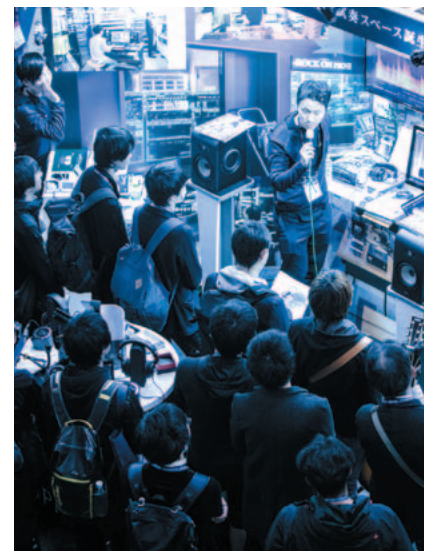

Inter BEE 2019 Exhibition Regulations

4-17. Demonstration regulations

1. Copyrights

Exhibitors playing music or replaying recorded audio or video material must pay royalties on said material (unless the exhibitor owns the rights or has made separate arrangements for payment of royalties).

Royalties are payable to the Japanese Society for the Rights of Authors, Composers and Publishers (JASRAC), which handles royalties in Japan.

Please contact JASRAC for details on arrangements and royalty calculation methods. In addition, when exercising rights regarding video and animation, please contact the company or organization/group that owns the copyright.

2. Illumination / Lighting

No illumination that projects directly into another company's lighting or onto walls or corridors is permitted. Exhibitors in the Professional Lighting category who need to illuminate in distance to describe or feature its exhibit product may illuminate only towards the ceiling within the exhibitor's booth.

When strong lighting equipment such as LEDs are used in displays and / or signboards, they must be positioned so as not to inconvenience visitors or neighboring booths.

3. Smoke machines

The use of smoke machines (including alcohol, oil or petroleum smoke machines, and dry ice machines) is not permitted.

4. Other

Please take preventive measures to avoid the generation of the following during demonstrations. Please be considerate of other exhibitors and visitors.

1. Hot air 2. Gases 3. Odors 4. Vibration

4-18. Handling of hazardous items

1. The Fire Prevention Law Prohibits the Following Activities on the Exhibition Site

- Smoking
- Live flames (spark-producing items, exposed elements, etc.)
- Liquefied petroleum gas (LPG) or other flammable / pressurized gases
- Hazardous objects (gasoline, kerosene, other oils, etc.)
- Hazardous materials
(explosives, matches or disposable lighters in large quantities, etc.)

2. Exemptions for prohibited activities

Excluding smoking, exemptions for prohibited activities and / or the use of some of the aforementioned substances may be granted by local fire safety authorities if it is determined that only minimal amounts of substances will be used or that the activities are necessary to enhance the exhibit. For exhibitors seeking exemptions, please fill in the relevant items on the "Hazardous Materials Usage Application" in the exhibitor's manual and submit the form together with two declaration copies explaining the nature of the performance or exhibit. The association will submit all applications to the fire safety authorities at a single time, and only the items granted exemptions will be allowed to be used in the venue.

3. Smoking

Smoking is prohibited in booths. Smoking is permitted only in specially designated smoking areas.

4. Live Flames

The following should be strictly observed when using live flames:

- Minimize the size and quantity of on-site equipment to the extent possible and use devices of the same type.
- Protect the surrounding area with fireproof materials.
- Monitor conditions closely and provide adequate fire safety equipment.
- At least one fire extinguisher must be available (with a 2-unit minimum fire extinguishing capability and a minimum size of 10).
- A designated person responsible for fire prevention and extinguishing any possible fire must be stationed in the booth.
- Live flames must be at least 5 m from fire exits, hazardous materials and other flammable materials

5. Liquefied Petroleum Gas (LPG) or Pressurized Gas

The following rules should be strictly observed when using LPG and other pressurized gases (oxygen, hydrogen, nitrogen, carbon dioxide, argon gas, etc.):

- After installation, test all containers for leaks, and if necessary display a "Caution: Do Not Use Near Flammables" sign on them.
- Use pressurized gases under the lowest possible pressure, and handle containers carefully. Bringing flammable gas cylinders (except cartridge types) onto the exhibition site is prohibited.
- To prevent gas leakage, use a complete connector for all connecting parts and monitor continuously with a gas leak detector.

6. Hazardous Materials

When using hazardous substances in the exhibition venue, the following regulations must be strictly observed.

- Bring only one day's supply or less onto the exhibition site.
- Do not replenish supplies during exhibition operating hours.
- Provide adequate fire safety measures and handle materials carefully at all times.
- Place hazardous materials 6 m and other materials 3 m or more from fire escapes.
- A Type 10 fire extinguisher must be readily available.
- Place hazardous materials 5 m away from areas in which open flames are being used.
- Appoint personnel to monitor safety.

4-19. Violation of the regulations and discrepancies in interpretation

Concerning official regulations, if an exhibitor violates regulations or if there is a discrepancy in interpretation or the application of these regulations, the following measures will be taken. Please note that the interpretation of the regulations as defined in the original Japanese language documentation will take precedence.

1. If the Organizing Committee determines that an exhibitor has violated regulations governing exhibitor booths and implementation of exhibits, the association will request that the exhibitor take the necessary corrective measures.

2. If the same violation described in section 1 above occurs again, or a discrepancy in interpretation of these regulations occurs, the Organizing Committee will take the appropriate action and as a final ruling order, order the exhibitor in question to take the necessary corrective measures.

Please note that once the committee reaches a final ruling, the committee will not enter into any further discussion with the exhibitor in question, nor be responsible for any incurred liabilities whatsoever.

3. If an exhibitor has been ordered to take corrective measures described in section 2 above, the exhibitor will be required to submit in writing on the same day, a description of the necessary corrective measures taken and the schedule at which they will be completed.

4. If an exhibitor has been ordered to take corrective measures described in section 2 above, and fails to do so accordingly, or if the corrective measures taken are determined to be insufficient by the Organizing Committee, the following penalties may apply.

- The exhibitor will be prohibited from continuing with exhibition activities from the next day.
- If the penalty in section 1 above is not abided to, the exhibitor will be barred from exhibiting at the subsequent Inter BEE exhibition.

4-20. Others

1. Other prohibited activities and regulations that are not included in these regulations will be detailed in the Exhibitor Manual that will be distributed at a later date.

2. Promissory notes cannot be accepted for payment for booth fee and all the expenses. Transfer fees are to be borne by the exhibitor.

3. These regulations are subject to change as deemed necessary by the show sponsors, the Organizing Committee or the association. If changes occur to the regulations, they will be posted on the Inter BEE Official Website, or brought to the attention of exhibitors by other means.

4. Observing these regulations is the sole responsibility of the exhibitor. The show sponsors, Organizing Committee and the association will not accept any responsibility resulting from violations of existing laws and / or local ordinances by exhibitors.

4-21. Organizing Committee

The Organizing Committee functions as a body to deliberate and decide matters related to the management of the exhibition, including regulations and plans. The Organizing Committee will be represented at the exhibition site during the preparation and execution phases of the exhibition. These representatives will be responsible for maintaining the exhibition environment, dealing with problems and ensuring that the exhibition regulations are adhered to at all times. They have the authority to address problems as they arise.

Basic Policy and Organizational Framework concerning Disaster Prevention and Safety Measures

1. Basic Policy

The Management Office will respond to disasters in accordance with its basic principle of "prioritizing the safety of visitors and exhibitors".

In the event of a disaster, the Management Office will assemble a local disaster prevention organization to gather and provide information, give evacuation instructions, and conduct initial fire-fighting and rescue activities. The Management Office will also cooperate with Makuhari Messe to circulate information between concerned organizations, and strive to ensure the safety of all parties concerned.

2. Organizational Framework

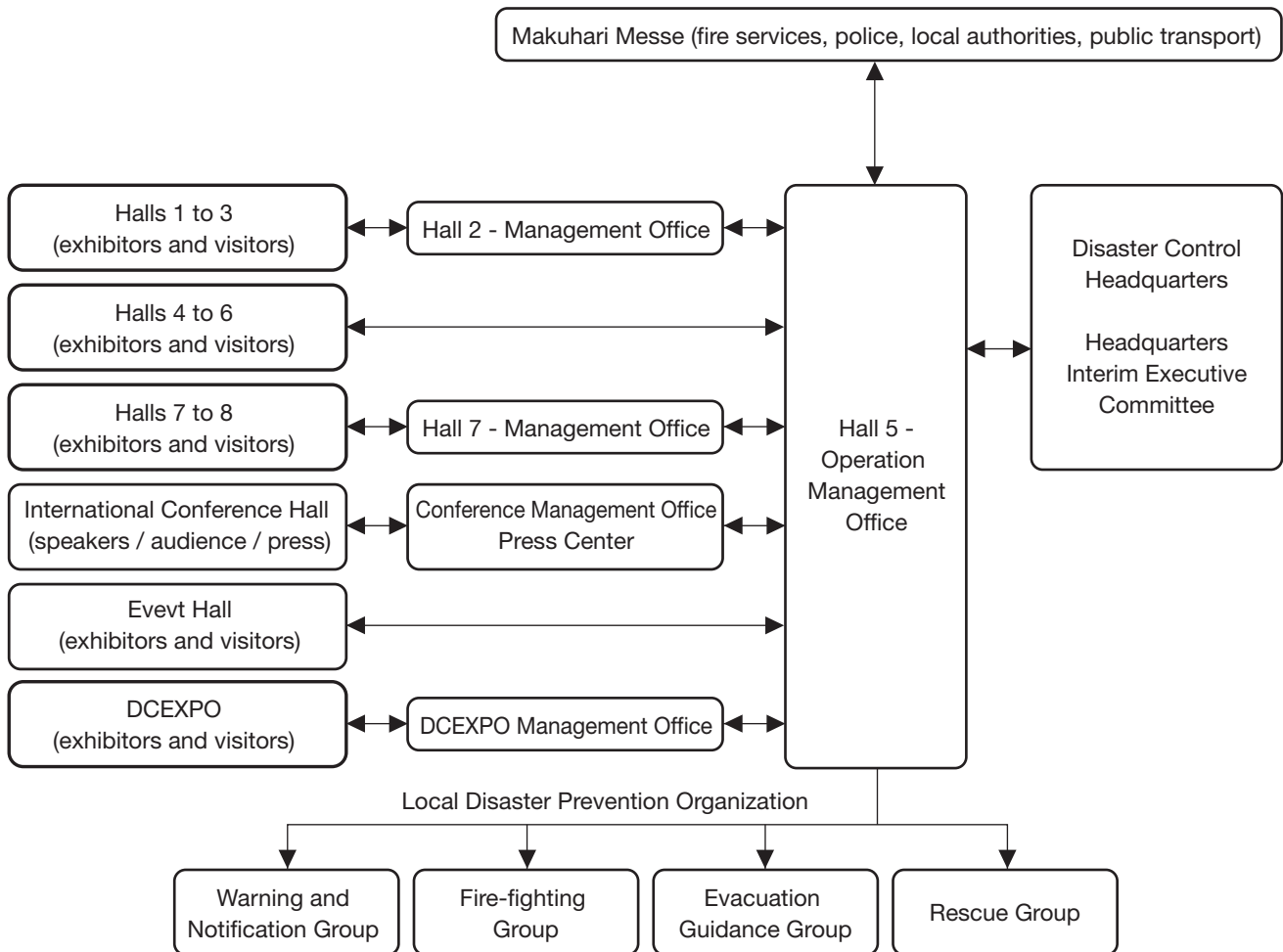

Requests to Exhibitors Concerning Disaster Prevention and Safety Measures

In order to operate a safe exhibition Inter BEE has formulated a "Disaster Prevention and Safety Measures Manual", so we hope that exhibitors can cooperate with the following requests.

1. Advance Preparations

We recommend that all exhibitors refer to the below items and formulate their own safety and disaster prevention manual.

The Management Office has separately issued a "Disaster Prevention and Safety Measures Guidelines" for exhibitors formulating manuals, so please make use of these reference materials.

<p>(1) Registering with the Management Office</p> <p>*All exhibitors must submit</p>	<ul style="list-style-type: none"> ① Contacting the booth manager So that the Management Office can contact you in the event of an emergency, register the mobile phone number and e-mail address of the person in charge of the booth with the Management Office by Friday, October 25 via the "Registration of Booth Manager and Booth Staff". Information that you register with us will be managed in accordance with personal information protection policy when holding this event and will be deleted after the conclusion of the exhibition. ② Number of booth staff Please register the estimated maximum number of staff (company employees, external staff, part-time workers, etc.) occupying and working at the booth for each day to the Management Office by Friday, October 25 via the "Registration of Booth Manager and Booth Staff". The Management Office will provide this information to public organizations such as the police or fire-fighting services in the event of a disaster.
<p>(2) Booth disaster prevention and safety measures</p>	<ul style="list-style-type: none"> ① Formulate a disaster prevention and safety manual to be used in the management of the booth ② Establish an emergency contact network and select contact managers (own company, partner companies, Management Office) ③ Divide roles among staff members <ul style="list-style-type: none"> • Ensure visitor safety and give evacuation instructions • Ensure the safety and confirm the whereabouts of booth staff • Support rescue activities • Maintain the booth (stop demonstrations, stop transmission of electrical energy, look after exhibit products, etc.) ④ Prepare disaster equipment <ul style="list-style-type: none"> • Basic emergency set • Flashlight, etc. ⑤ Check the the site <ul style="list-style-type: none"> • Confirm suspected danger spots in the booth • Confirm the closest primary evacuation place (open spaces such as wide aisles and resting place) • Confirm the closest evacuation exit and route • Confirm the location of fire-extinguishers • Participate in the emergency drill* <p>*9.00-9.15 13th November (Wed.) (for more details refer to section 01-2-5)</p>

Requests to Exhibitors Concerning Disaster Prevention and Safety Measures

2. Safety Precautions when Setting Up Booths

After taking into consideration possible disaster scenarios, exhibitors are requested to take the following safety measures when designing and setting up their booth.

<p>(1) Electrical work</p>	<ul style="list-style-type: none"> ① Booth staff will circulate information on the location of temporary distribution boards and select a person to be responsible for turning off the breaker in the event of an emergency. The temporary distribution board to be installed by the Management Office (primary mains work) will act as an earth leakage breaker that automatically cuts off the electrical supply when an earth leakage is detected. ② Do not conceal the temporary distribution board. Also, be sure not to place any packages etc. in front of the temporary distribution board. ③ When installing large-scale lighting equipment such as PAR lighting fixtures, be sure to take measures to prevent them falling such as securing them with wire. <p style="text-align: right;">*For more details please refer to section 04-2-5</p> <div data-bbox="1029 772 1428 996" style="border: 1px solid black; padding: 5px;"> </div>
<p>(2) Designing and setting up booths</p>	<ul style="list-style-type: none"> ① When designing block booth be sure to keep 1/3 (one-third) of the side adjacent to the aisle open to allow for an evacuation route. ② To prevent truss beams falling, strike four or more anchor bolts in one place when securing them to the floor. ③ When installing exhibition panels (OCTANORM), take measures to prevent them falling by reinforcing the panels, reinforcing the beams in the corner sections, and installing weights. ④ Take measures to prevent independent fixtures falling by securing them to the wall or floor surface. ⑤ When installing video monitors, speakers, channel characters, lighting fixtures, and other fixtures located in high places; take measures to prevent them falling by securing them with bolts or wires. <p style="text-align: right;">*For more details please refer to section 04-1-3</p> <div data-bbox="1061 1254 1428 1646" style="border: 1px solid black; padding: 5px;"> </div>
<p>(3) Safety while working</p>	<ul style="list-style-type: none"> ① People working in high places must wear a helmet and a safety belt. ② When using a stepladder for work, be sure to secure it with an anti-opening bracket. ③ When using a rolling tower, be sure to install a handrail and outrigger with a height of at least 900mm around the work floor.

Exhibitors' Response to an Emergency

Please be prepared to act in the event of an emergency by informing all booth staff about how to respond to a disaster.

Earthquake	During	<ul style="list-style-type: none"> •Prioritize your own safety •Secure the safety of booth visitors and booth staff (guide people to the primary shelter)
	Straight after	<ul style="list-style-type: none"> •Give booth visitors evacuation instructions in accordance with officials' instructions when evacuation orders appear outside the evacuation hall over the P.A. system •Continue to evacuate all booth staff •Persons in charge of the booth will maintain the booth (stop transmission of electrical energy, look after exhibit products, etc.)
	After	<ul style="list-style-type: none"> •Support rescue activities as necessary •Confirm the safety of booth staff and identify the status of damage •Make a report to the Management Office
Fire	When discovered	<ul style="list-style-type: none"> •Ensure people's safety (instruct visitors and exhibitors in the near vicinity to evacuate) •Notify the Management Office
	During	<ul style="list-style-type: none"> •Conduct initial fire-fighting activities with a fire extinguisher (prior to the Management Office dealing with the problem)
Suspicious objects	When discovered	<ul style="list-style-type: none"> •Notify the Management Office
Incidents	During	<ul style="list-style-type: none"> •Ensure people's safety (instruct visitors and exhibitors in the near vicinity to evacuate) •Notify the Management Office
	After	<ul style="list-style-type: none"> •The victim files a damage report •Police investigate and deal with the problem
Emergency	During	<ul style="list-style-type: none"> •Check the well-being of people being rescued •If moderate: Lead people to the first-aid center or the closest Management Office location •If serious: Call for an ambulance (if requested by the person concerned or the person accompanying the injured person) <div style="border: 1px solid black; padding: 5px; margin: 5px 0;"> <p>▶ Primary action: _____</p> <p>Contact the Management Office</p> <p>→ call an ambulance from the Management Office's office</p> <p>→ the Management Office will guide the ambulance into the grounds</p> </div> <div style="border: 1px solid black; padding: 5px; margin: 5px 0;"> <p>▶ Urgent situations: _____</p> <p>Directly request an ambulance by calling direct from your mobile phone</p> <p>→ notify the Management Office</p> <p>→ the Management Office will guide the ambulance into the grounds</p> </div> <p>*Prioritize the well-being and wishes of the people being rescued</p>

Disaster Evacuation Route

1. Evacuation orders

If necessary, the Management Office will give instructions via the P.A. system to evacuate people to the outside the exhibition hall.

2. Example of emergency broadcast message

(1) In the event of a fire:

"This message is for everyone in the venue. There is currently a fire in the vicinity of ○○. The disaster prevention organization has started to deal with the fire, so please calmly follow the instructions of officials and evacuate to the outside of the exhibition hall via the emergency exit."

(2) In the event of an earthquake

① Straight after

"This message is for everyone in the venue. An earthquake has just occurred. Ensure your own safety such as watching for falling objects, and please wait a while in a safe location within the venue. The Makuhari Messe building is supported by a safe structure. We will let you know as soon as we have more details."

② Evacuation order

"This message is for everyone in the venue. An earthquake centered in ○○ measuring at ○○ on the Japanese scale has just occurred. Although the Makuhari Messe building is supported by a secure structure, booths and exhibits may collapse due to aftershocks, so please calmly follow the instructions of officials and evacuate to the outside of the exhibition hall via the emergency exit."

③ In the event of a tsunami warning

"This message is for everyone in the venue. An earthquake centered in ○○ measuring at ○○ on the Japanese scale has just occurred. A tsunami warning has been announced at Tokyo Bay, so please calmly follow the instructions of officials and evacuate to the second floor of the exhibition hall via the emergency exit." The second floor is 11 meters above sea level."

(3) Incidents (bomb warning, etc.):

- ① Calling for attention: "Sakura sakura" (music) played 5 times in succession.
- ② Warning lifted: "Tooryanse" (music) played 5 times in succession

3. Evacuation guidance

Please act calmly and follow the instructions of the Evacuation Guidance Group.

Disaster Evacuation Route

4. Evacuation route

(1) When evacuating to the outside of the Exhibition Hall

When evacuating to the outside of the Exhibition Hall in event of an earthquake or fire, etc., please go to the outside of the exhibition hall shutters.

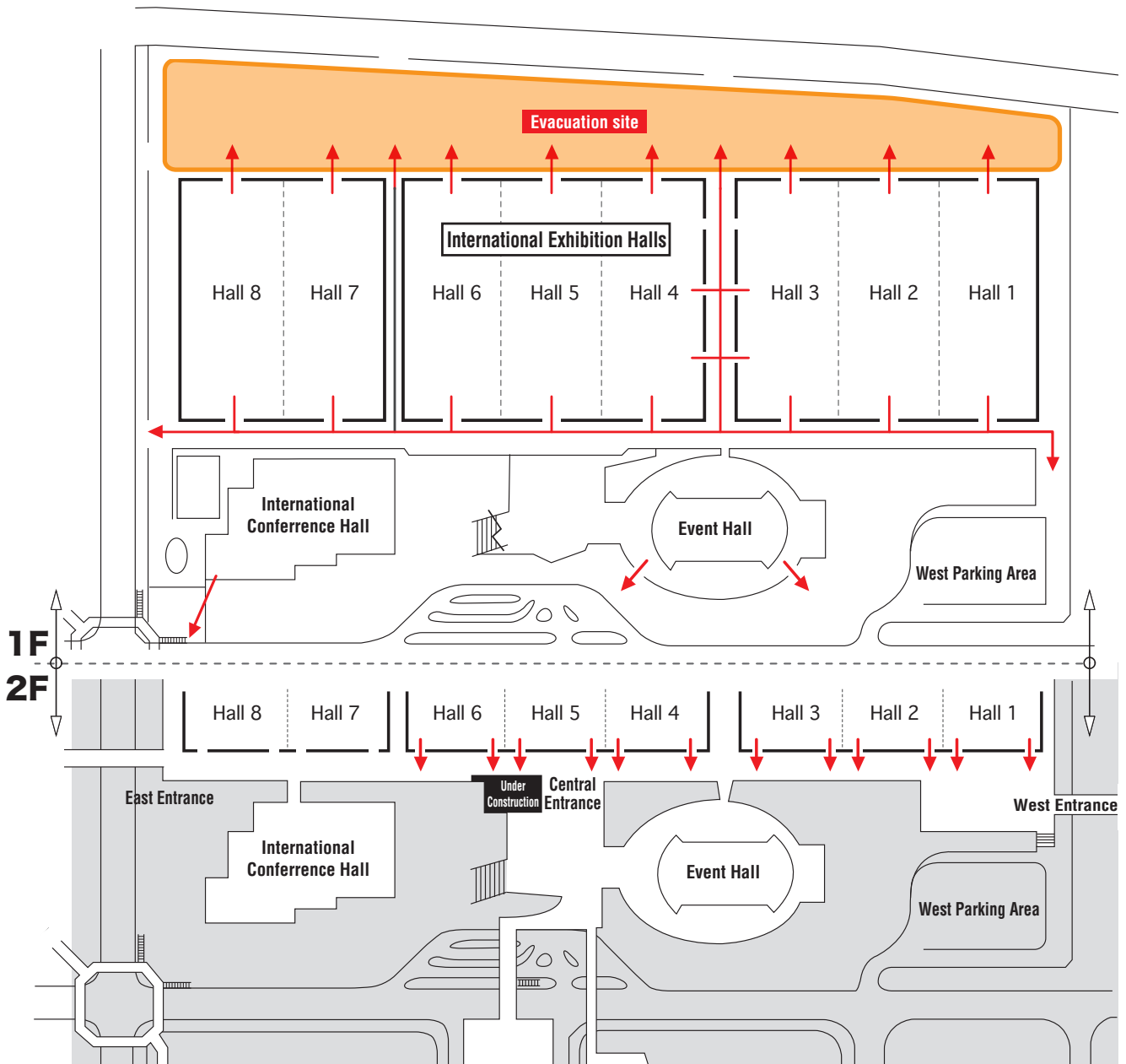

Disaster Evacuation Route

(2) When evacuating after a tsunami warning

When a tsunami warning is announced, evacuate to the second floor aisles of Makuhari Messe or to Messe Mall.

* 1st floor of Makuhari Messe exhibition hall - 8m above sea level; 2nd floor of the exhibition hall - 11m above sea level

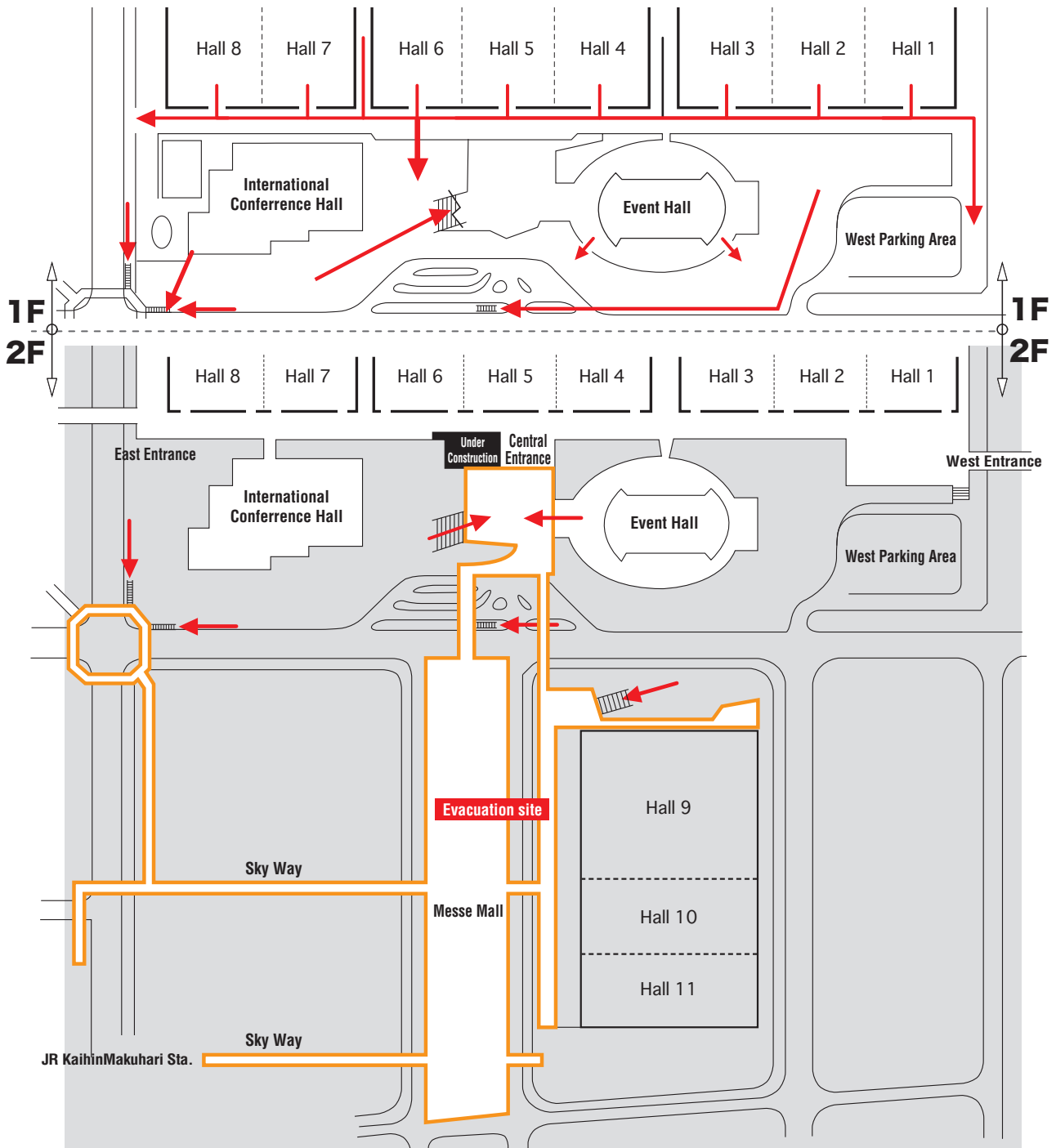

Emergency Drill

We will carry out the below described exhibitor emergency drill to ensure that safety is secured and evacuation instructions are provided swiftly in the event of a disaster.

While we understand that this will be held during a busy time of the day for all exhibitors, we hope that all booths will cooperate when the P.A. system announces the drill. (Voluntary)

Date: November 13 (Wed.) 9:00-9:15

	Organizer	Local Disaster Prevention Organization	Exhibitors
9:00 a.m.	Scenario: Occurrence of a strong inland earthquake		
9:01 a.m.	P.A. system announcement (Status report and request to ensure safety)	Evacuation Guidance Group's allocation of emergency exits	Simulation of evacuation instructions (voluntary)
9:03 a.m.	P.A. system announcement (mock earthquake and evacuation orders)	Open emergency exits and start guiding people to the evacuation point	Confirm emergency exits and inform all staff
9:05 a.m.	Confirm and notify the damage(request fire-fighting and emergency services)	Ensure safety and confirm the status of damage Confirm a fire	Confirm the safety of booth staff and the booth
9:10 a.m.	Confirm venue safety	Confirm people requesting help	Summarize information for managers
9:15 a.m.	P.A. system announcement (Order to disband)		

Requests to Help Save Energy

1. Energy saving activities

However, considering that energy-saving activities are impacting companies and households through the government's announced "Summertime Energy-Saving Measures" (electrical power supply and demand review meeting), Inter BEE is voluntarily conducting the following activities to save energy.

While this may cause exhibitors some inconvenience, we hope to rely on your understanding and cooperation.

2. Energy saving measures by the Management Office

- (1) Reduced air conditioning services
 - (2) Cutting ceiling lights at second floor common areas and restaurants
-

3. Exhibitors' energy-saving measures

- (1) Use of components with low consumed power (LED lights, etc.)
 - (2) Energy saving considerations when designing booths
-

4. Cool Biz energy-saving campaign

Promote Cool Biz throughout the event

Personal Information Protection Policy of Japan Electronics Show Association

Privacy Policy

Personal Information, or Personally Identifiable Information, as used in this document means information about an individual user which can identify a specific individual by name, gender, age, address, telephone number, e-mail address, service access record, or other description, or uniquely assigned number or symbol contained in the information. It includes information that allows easy reference to other information which can identify a specific individual.

1. Concerning Personal Information

The Japan Electronics Show Association ("the Association" hereinafter), made up primarily of electronic equipment and parts manufacturers cooperating with event organizers, is responsible for holding exhibitions and seminars designed to further develop information technology industries in Japan. In this and all other of its business activities, the Association fully understands the importance of properly handling and protecting personal information.

Therefore, the Association will properly safeguard personal information obtained through any of its business activities that could be used to identify individuals in complete compliance with existing laws and guidelines governing personal information. Specifically, the kind of personal information that the Association will safeguard is any information collected via written documentation, electronic media, websites, etc., which can be used to identify particular individuals through details such as names, addresses, phone numbers, email addresses or places of employment (includes information not directly related to individuals but such that could easily be used with other data for identification).

2. Use of Personal Information

Personal information obtained through the Association's business activities and/or affiliated operations will be used for the following purposes in accordance to regulations stipulated in the Association's articles of incorporation:

- (1) For sending reports or other information related to business activities of the Association.
- (2) For the operation of exhibitions, seminars, lectures and other events that are the responsibilities of the Association*.
- (3) For the operation of the Association's website.
- (4) For the creation and distribution of documents related to the Association's business activities (journals, reports, proposals etc.).
- (5) For answering inquiries and addressing comments concerning the Association and its business activities.
- (6) For sending notifications, questionnaires, related communications, etc. concerning the Association and its business activities.
- (7) For all other correspondences concerning the Association and its business activities.

*The Association gathers personal information to improve the performance of its business activities, to obtain entry information at exhibition venues, and garner data on conference reservations/attendance data. The Association also collects personal information to create questionnaires and to respond to requests for reference materials. Personal information may also be gathered to provide registered exhibition visitors with promotional information on the products and services available from companies related to exhibitions. The Association uses personal information only within the scope of these purposes.

3. Providing Personal Information to Third Parties

In situations other than those listed below, personal information collected by the Association will not be provided to third parties. QR code systems is used at events operated by the Association, and personal information is garnered from both visitors performing registration procedures in advance via the website and those participating in the exhibition during the time it is held. The Association makes available to relevant companies, groups, etc. or seminar operators, the personal information garnered from visitors who visit exhibitor booths at the venue and present their admission passes/badges. Please be aware that this information may also be used by exhibitors or seminar operators at a later date to send pertinent guidance materials to visitors via email or the postal service.

- (1) When prior consent has been obtained from the individual(s).
- (2) When there is a legal obligation to provide personal information.
- (3) When it is difficult to obtain the consent of the individual(s) but disclosure is required to protect an individual's property or safety.
- (4) When it is difficult to obtain the consent of the individual but disclosure is required to enhance public safety or promote children's health and welfare.
- (5) When obtaining the consent from the individual(s) may be difficult to obtain in situations where disclosure is necessary for cooperation with a national organization, local authorities and/or contractors in accordance with laws.

Even when personal information is disclosed to third parties in accordance to the aforementioned topics, the Association may restrict access or disclosure as it deems necessary.

Personal Information Protection Policy of Japan Electronics Show Association

4. Concerning websites related to the Association | Exhibition websites operated by the Association use the usage information and record in cookies, smartphones to customize services for individual users and to tally page views. While individual IP addresses are collected to collate data and monitor trends on website usage, these addresses are not used in any way to facilitate the identification of individual users. However, this stipulation shall not apply if the legitimate legal rights of the Association are, or could potentially be interfered with or infringed.
5. Managing Personal Information | The Association carefully manages the personal information it acquires within the guidelines of the aforementioned objectives, and initiates strict security measures to protect personal information from unauthorized access, disclosure, copying, use or modification. As for business activities entrusted to the Association by affiliated companies, it will also comply with the respective company's personal information policies. When personal information is handled by non-affiliate companies, the Association will instigate nondisclosure agreements with these companies and supervise them.
6. Disclosure, Modification, Termination, etc. of Personal Information | When a user requests disclosure, modification, termination, etc. of their personal information, the Association will respond promptly and prudently on the matter.
7. Personal Information Managing System | The Association has a management system that is supervised by its Secretary-General to help ensure a consistent, thorough approach to personal information protection by the managerial staff.
8. Inquiries | For any inquiries concerning the protection and/or disclosure of personal information maintained by the Association, please contact us at:

**Japan Electronics Show Association (JESA)
Administration Section**

5F Ote Center Bldg., 1-1-3 Otemachi,
Chiyoda-ku, Tokyo 100-0004, Japan

Tel: +81-3-6212-5231 Fax: +81-3-6212-5225

Use of Personal Information by Exhibitors

■ Use of Personal Information by Exhibitors

With respect to the handling of visitors' personal information, the Association shall adopt the aforementioned measures in order to fulfill the requirements of the Personal Information Protection Law. All exhibitors are also required to fulfill the requirements of the Law. The Association therefore requests that exhibitors strictly observe and implement the following items with regard to the handling of personal information obtained at Inter BEE

- ◆ Methods shall be devised for confirming the wishes of the provider (individual) regarding the use of business cards, names written on name lists, information written on survey forms, details written on business cards or personal information obtained using the barcode system.
- ◆ Business cards, names written on name lists, information written on survey forms, details written on business cards or personal information obtained using the barcode system must not be resold.
- ◆ Business cards, names written on name lists, information written on survey forms, details written on business cards or personal information obtained using the barcode system must be used only by the departments and divisions of one's company and must not be passed on to other departments or divisions.
- ◆ In cases where the provider of collected personal information requests not to be contacted, or the information is not to be provided to others, and also in cases where the individual has made it clear that he / she wants the information deleted or erased, use of that personal data is to be stopped immediately, and appropriate measures taken. Also, in cases where the provider of personal information requests disclosure of details held, steps must be taken to provide a response as soon as possible.
- ◆ Appropriate measures must be devised under the guidance of the person in charge of the management of personal information to prevent the leaking of personal information contained on business cards, names written on name lists, information written on survey forms, details written on business cards or personal information obtained by using the barcode system.
- ◆ Exhibitors shall be responsible for the management of business cards, names written on name lists, information written on survey forms, details written on business cards or personal information obtained using the barcode system.

Other appropriate measures shall be taken in accordance with the Personal Information Protection Law.

■ Handling of Personal Information Collected at Booth

When collecting personal information from visitors at booths (apart from data supplied through the barcode system), we recommend that you inform them about the intended use of such information and obtain their prior consent. Samples of items visitors are to be advised of at reception desks are provided on the next page. Please use these as a guide for written notices based on your company's policy regarding the protection of personal information.

Use of Personal Information by Exhibitors

- Examples of written notices on the handling of personal information by Company X

Receiving business cards Please provide us with one business card.

Surveys We ask for your cooperation in taking part in this survey.

Use of barcode system We will ask permission to scan your barcode.

Our company will use personal information collected for the following purposes, and it will be managed and handled according to stringent protocols.

Purposes of Using Personal Information

- ◆ To allow our sales representative to contact you concerning our products on display.
- ◆ To inform you about our products, services, seminars and events.
- ◆ To invite you to the next Inter BEE exhibition and provide other information.

Handling of Personal Information

- ◆ We shall not provide personal information to a third party without your consent.
- ◆ We shall manage personal information strictly in accordance with our protocols for its safe management so that such information is not lost, destroyed, falsified or improperly disclosed.
- ◆ We perform appropriate data maintenance to ensure the accuracy of personal information that we obtain. If requested by the person in question to disclose, amend, cease using or delete his or her information, we shall endeavor to do so in an appropriate manner and without delay.

For further enquiries on this matter, please contact the following office.

X, Inc., ABC Division
Contact: Bill Smith
Tel: 123-4567-8910
E-mail: aaa@zzzz.com

Payment of Charges

Page	Service details	How to pay	When to pay
2-3-3	VIP Room	Japan Electronics Show Association	Early December after the closing of Inter BEE 2019
2-4-1	Invitation Leaflet	Japan Electronics Show Association	
2-4-2	Visitor Data Scanning Service	Japan Electronics Show Association	
2-5-1	Presentation Room	Japan Electronics Show Association	
2-5-2	Meeting Room	Japan Electronics Show Association	
2-6-2	E-mail Magazine Text Banner Ads	Japan Electronics Show Association	
2-6-3	Strap Advertising	Japan Electronics Show Association	
2-6-4	Guide Map Advertisement	Japan Electronics Show Association	
2-6-5	On-site Signboard Ads	Japan Electronics Show Association	
3-2-1	Overtime Work	Japan Electronics Show Association	
3-2-2	Additional Exhibitor / Worker Budes	Japan Electronics Show Association	
4-2-5	Power Supply	Japan Electronics Show Association	
4-2-5	Electrical Power Work Installation Diagram	Japan Electronics Show Association	
4-2-5	Optional Power Transmission	Japan Electronics Show Association	
4-2-6	Green Power Certification System	Japan Natural Energy Company Limited	A / N (As needed)
4-3-1	Foreign-Made Product Exhibition Plan	Ishikawa-Gumi Ltd.	Early December after the closing of Inter BEE 2019
4-5-2	Exhibitors' Utility Booths	Japan Electronics Show Association	
5-1-1	Transport within Japan Load-in / Load-out Services	Ishikawa-Gumi Ltd.	
5-2-2	PC Rental	Kissei Comtec Co., Ltd.	
5-3-1	Internet Connection	Makuhari Messe Inc.	
5-3-3	Antenna Installation	Makuhari Messe Inc.	
5-3-4	Cabling Between Booths	Makuhari Messe Inc.	A / N (As needed)
5-4-1	Hotel Reservations	Kinki Nippon Tourist Metropolitan CO., LTD	
5-4-2	Food / Beverage Tickets	Makuhari Messe Inc	
5-4-3	Lunch Box Delivery Service	Wako Sangyo Co., Ltd.	
5-4-4	Catering Service for Booths	Nilax Inc.	Early December after the closing of Inter BEE 2019
5-4-5	Part-time Staff / Interpreter	Ken & Staff Co., Ltd.	
5-4-6	Booth Photography	SHIRO-FILM	
5-4-7	Booth Cleaning	Chibaken Bldg-Maintenance Corp.	
4-2-3	Floor Work	Murayama Inc.	1 week prior to the opening of Inter BEE 2019
5-2-1	Booth Display & Rental Fixtures	Murayama Inc.	
5-3-2	Telephone Line	Murayama Inc.	

Inquiries List

Management Office	Address / Tel. / Fax/ E-mail	Contact	Related document
Japan Electronics Show Association (JESA)	5F Ote Center Bldg., 1-1-3 Otemachi, Chiyoda-ku, Tokyo 100-0004, Japan Tel: +81-3-6212-5231 Fax: +81-3-6212-5225 E-mail: exhibitor@inter-bee.com	Mori Yoshinaga Oda	General

Item	Management Office	Address / Tel. / Fax / E-mail	Contact	Related document
Invitation Leaflet Additional Exhibitor / Worker Budes	Daiichiprinting Co., Ltd.	6F Daiichinegishi Bldg., 2-14-18 Negishi, Taitou-ku, Tokyo 110-0003, Japan Fax: +81-3-5603-7034 E-mail: interbeesupport@dip.co.jp	Inomata Endo Yoshida	02-4-1 03-2-2
Visitor Data Scanning	Plott Corporation	5F Shiba Nishii Bldg., 4-9-1 Shiba, Minato-ku, Tokyo 108-0014, Japan Tel: +81-3-5730-1400 Fax: +81-3-5730-1401 E-mail: interbee-app@ml.plott.co.jp	Kudo Sato	02-4-2
Ceiling Construction	Makuhari Messe, Inc. Business Operations Sect II	2-1, Nakase, Mihama-ku, Chiba-shi, Chiba Prefecture 261-8550, Japan Tel: +81-43-296-0602 Fax: +81-43-296-0529 E-mail: ikegami@m-messe.co.jp	Ikegami Aoki	04-1-4
Booth Display, Hazardous Items, Floor Work, Temporary Telephone Service, Rental Furniture, Package Booth(s)	Murayama Inc.	3-2-24, Toyosu, Koto-ku, Tokyo 135-0061, Japan Tel: +81-3-6221-1960 Fax: +81-3-6221-1914 E-mail: interbee@murayama.co.jp	Shimizu Shibata Mochizuki	04-2-1 04-2-3 04-5-1 05-2-1 05-3-2
Electrical Work	Shoho Denki Co., Ltd. (Hall 1-4)	1-28-15, Kamiikebukuro, Toshima-ku, Tokyo 170-0012, Japan Tel: +81-3-3918-7993 Fax: +81-3-3918-7800 E-mail: interbee-work@shohodenki.co.jp	Ito Suzuki	04-2-5
	Suzuki Denki Co., Ltd. (Hall 5-8)	2-12-15, Hanakawado, Taito-ku, Tokyo 111-0033, Japan Tel: +81-3-3842-8201 Fax: +81-3-3845-3040 E-mail: event@suzukidenki.co.jp	Yoda Nakamura	
Bonded Goods, Loading Work on the Show Site, Move-in and Move-out Work (in Japan)	Ishikawa-Gumi, Ltd.	4-14-2, Higashiooi, Shinagawa-ku, Tokyo 140-0011, Japan Tel: +81-3-3474-8102 Fax: +81-3-5460-9841 E-mail: m_hasegawa@ishikawa-gumi.co.jp	Hasegawa Saito	04-3-1 05-1-1
In-booth wireless LAN Internet Connection Cabling Between Booths	Makuhari Messe, Inc. Telecommunications dept.	2-1, Nakase, Mihama-ku, Chiba-shi, Chiba Prefecture 261-8550, Japan Tel: +81-43-296-0493 Fax: +81-43-296-0492 E-mail: messe-kaisen@bz01.plala.or.jp	Otsuka	04-4-3 05-3-1 05-3-4

Inquiries List

Item	Management Office	Address / Tel. / Fax/ E-mail	Contact	Related document
PC Rental	KISSEI COMTEC CO.,LTD.	3-32-1 Minamiotsuka, Toshima-ku, Tokyo 170-0005, Japan Tel: +81-3-6709-2440 Fax: +81-3-5979-6335 E-mail: interbee@network.kcrent.jp	Mochizuki	05-2-2
Antenna Installation	Makuhari Messe, Information Machine Room Tofuna Eizo Inc.	2-1, Nakase, Mihama-ku, Chiba-shi, Chiba Prefecture 261-8550, Japan Tel: +81-43-296-0536 Fax: +81-43-296-0012 E-mail: makhari-m@tfvc.jp	Shishikura Uchida	05-3-3
Accommodation	Kinki Nippon Tourist Metropolitan CO., LTD	13F Kandaizumicho, Chiyoda-ku, Tokyo, 101-0024, Japan Tel: +81-3-6891-9354 Fax: +81-3-6891-9409 e-mail: ecc_iod19@or.knt.co.jp	Inter BEE Reservation Desk	05-4-1
Meal Ticket	Makuhari Messe, Inc. Facility Services Sect	2-1, Nakase, Mihama-ku, Chiba-shi, Chiba Prefecture 261-8550, Japan Tel: +81-43-296-0525 Fax: +81-43-296-0529 e-mail: snb-dn@m-messe.co.jp		05-4-2
Lunch box Delivery Service	Wako Sangyo Inc.	5-38-3, Kyodo, Setagaya-ku, Tokyo 156-0052, Japan Tel: +81-3-3427-8331 Fax: +81-3-3427-8332 e-mail: wako@star.odn.ne.jp	Kaneda Sano	05-4-3
Catering Service for Booths	Nilax Inc.	2-1 Nakase Mihama-ku, Chiba-shi, Chiba 261-8550, Japan TEL: +81-43-296-0512 FAX: +81-43-296-2003 e-mail: 9604@nilax.co.jp	Kotani	05-4-4
Receptionist interpreters	Ken & Staff Co., Ltd.	MST Hills, 4-4-5, Takadanobaba, Shinjuku-ku, Tokyo 169-0075, Japan Tel: +81-3-3367-0020 Fax: +81-3-3367-0027 E-mail: k-nashimoto@ken-staff.co.jp	Nashimoto	05-4-5
Booth photography	SHIRO-FILM	101,2-20-5 Masago Mihama-ku, Chiba-shi, Chiba 261-0011 Tel/Fax:+81-43-277-2324 E-mail: shiro-film@w7.dion.ne.jp		05-4-6
Cleaning Booth	Chibaken Bldg-Maintenance Coop. c / o Makuhari Messe, Inc.	2-1, Nakase, Mihama-ku, Chiba-shi, Chiba Prefecture 261-8550, Japan Tel: +81-43-296-0534 Fax: +81-43-296-0753 E-mail: cb-event@cbm.jp	sato	05-4-7
Copyright Royalties	Japan Society for Rights of Authors, Composers and Publishers (JASRAC) Tokyo Event / Concert Branch Office	5F Hibiya Building, 1-1-1 Shimbash, Minato-ku, Tokyo 105-0004, Japan Tel: +81-3-5157-1162 Fax: +81-3-3503-5552		04-4-2